

---

***J-1302***

—— CONTENTS ——

FIG.1 JOB SEPARATOR ..... 2

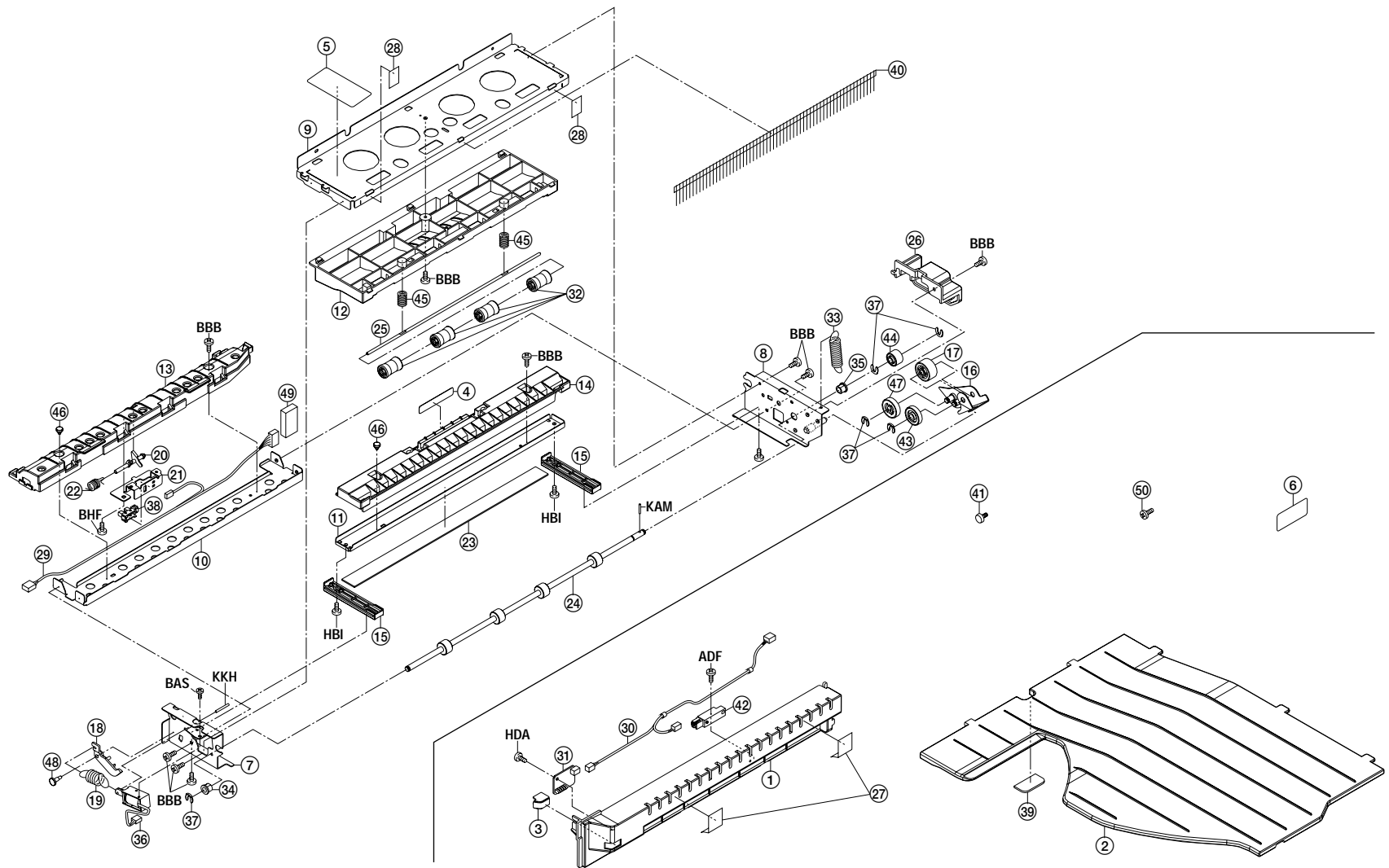

FIG. 1 JOB SEPARATOR

3A8

SP	Ref. No.	Part. No.	Description	Quantity		
				120V	230V	240V
●	1	3A804010	COVER,RIGHT EJECT	1	1	1
●	2	3A804020	TRAY,JOB SEPARATOR	1	1	1
●	3	3A804030	COVER,JOB SEPARATOR LED	1	1	1
	4	3A805020	LABEL,LOWER LEFT GUIDE	1	1	1
	5	3A805030	LABEL,RECOGNITION	1	1	1
	6	3A805040	LABEL,JAM REMOVENT	1	1	1
	7	3A821010	FRONT FRAME	1	1	1
	8	3A821020	REAR FRAME	1	1	1
	9	3A821030	UPPER STAY	1	1	1
	10	3A821040	LOWER RIGHT STAY	1	1	1
	11	3A821050	LOWER LEFT STAY	1	1	1
	12	3A821060	UPPER GUIDE	1	1	1
	13	3A821070	LOWER RIGHT GUIDE	1	1	1
	14	3A821080	LOWER LEFT GUIDE	1	1	1
	15	3A821090	RAIL,LOWER LEFT GUIDE	2	2	2
	16	3A821100	SUPPORT PLATE,JOINT	1	1	1
	17	3A821110	GEAR 21	1	1	1
	18	3A821120	LEVER,FEED SHIFT	1	1	1
	19	3A821130	SPRING,FEED SHIFT LEVER	1	1	1
●	20	3A821140	ACTUATOR,EJECT	1	1	1
	21	3A821150	HOLDER,ACTUATOR EJECT	1	1	1
	22	3A821160	SPRING,ACTUATOR	1	1	1
	23	3A821170	SHEET,LOWER LEFT STAY	1	1	1
●	24	3A821180	ROLLER,EJECT	1	1	1
	25	3A821190	SHAFT,EJECT PULLEY	1	1	1
	26	3A821200	COVER DRIVE	1	1	1
	27	3A821210	SHEET,COVER RIGHT EJECT	2	2	2
	28	3A821220	SHEET,UPPER STAY	2	2	2
	29	3A827010	WIRE,JOB SEPARATOR	1	1	1
	30	3A827020	WIRE,LED	1	1	1
●	31	3A828011	LED PCB	1	1	1
	32	2AV20160	PULLEY,EJECT	4	4	4
	33	48528216	SPRING,PAPER GUIDE	1	1	1
	34	29806560	BUSHING 6	1	1	1
	35	29806810	BUSHING,6 REGISTRATION	1	1	1
●	36	3AZ21890	SOLENOID,FEED SHIFT	1	1	1
	37	34806150	STOPPER 5	5	5	5
●	38	35327400	SWITCH,FEED	1	1	1
	39	35911350	PAD,ADF PAPER FEED	1	1	1
	40	63212210	STATIC ELIMINATOR,EJECT	1	1	1

SP	Ref. No.	Part. No.	Description	Quantity		
				120V	230V	240V
	41	64007010	PIN,CLEANER	1	1	1
●	42	66006360	PAPER SWITCH	1	1	1
	43	66014120	GEAR 14,MAGNET ROLLER	1	1	1
	44	66022190	GEAR,21 DEVELOPING	1	1	1
	45	68814720	SPRING B,DOCTOR BLADE	2	2	2
	46	48171300	PIN,TONER DISPOSAL TANK	2	2	2
	47	72906350	GEAR 20,REGISTRATION IDLE	1	1	1
	48	73912281	PIN,ORIGINAL HOLDER	1	1	1
	49	J0144110	CASE,1-175694-1(AMP)	1	1	1
	50	B1303050	BINDING SCREW BVM3X5 (BLACK)	2	2	2

- Parts with "●" are component parts or sub-assemblies of the assembly appearing immediately above them.
- Parts with "●" indicates the Service parts.